

LED signal bar light ONN-X2M-Waterfall light

Introduction:

1. With the characteristics of all LED products: energy saving and environmental protection, long life, is the inevitable trend of the future water lamp;
2. The luminous uniform, soft monochrome water effect standard models: red; Yellow; Green;
Can also be customized to do magic seven colors, simple and generous, exquisite and beautiful;
3. Small volume, saving space.



Application:

automation equipment, machine tool equipment, robot warning lights, etc.

Warranty: 2 years

Certification: CE, RoHS

Ordering code:

ONN X2M -	120	RYG	B
Model No.			Connection type Z. NPN B. PNP
Length(mm): 120 130 ... 940		Color Red, Yellow, Green, 7 colors	

Dimension(mm)

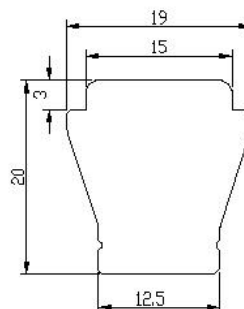

Parameter:

Model No.	ONN-X2M
Input voltage(current)	DC24V
IP rating	IP65
Beam angle	110 deg
Color	Red, Yellow, Green, any three colors and magic 7 colors
Material	PC + Aluminum PCB
Lifetime	50,000 hours
Working temperature/ humidity	-20~45℃ / 10%-90%
Storage temperature/ humidity	-40~70℃ / 10%-90%
Installation	Clips installation/ Recess installation

Wire connection:

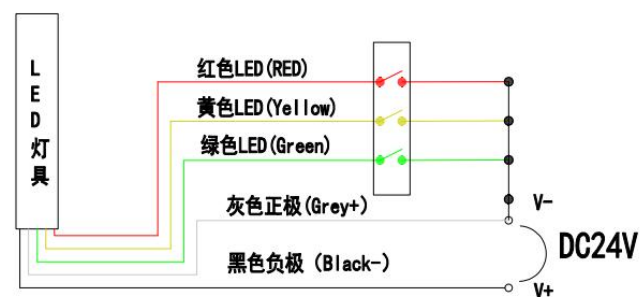

DC24V共正 (Common +)

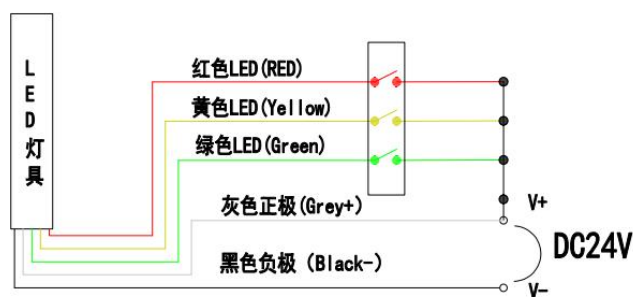

DC24V共负 (Common -)

External dimension(mm):

Length of lamp	120	130	140	150	160	170	180	190	200	~	930	940
length of the hole	116	126	136	146	156	166	176	186	196	~	926	936
Luminous surface width	15											
Hole width	16											

* Note: One driver for one luminance is standard, but one driver can be designed to connect multiple luminaries. Make sure the lamp is connected to the drive power supply, otherwise it may burn the lamp. For a single lamp more than two meters, 5V power supply needs to be added.

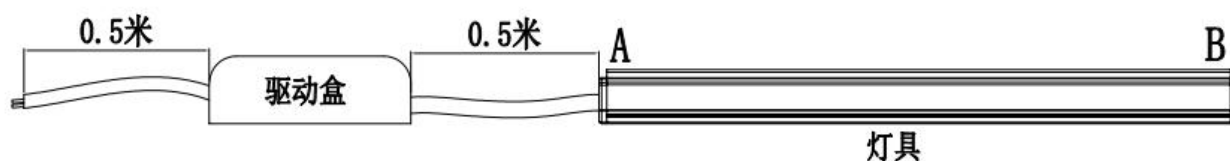

Before delivery the color, speed and direction of water can be adjusted according to demand (there are standard videos and custom effects for reference)

	Standard	Custom 1 fast speed	Custom 2 Slow speed		
water velocity	20	10	40		
Water lamp bead	15	5	20		
Spacer bead	3	5	1		
Standard flow direction (red) : B→A (yellow) : A→B (green) : A→B can be customized according to customer needs					

Package info

Product Length (mm)	778	1210	1534	1750
NW/pc(Kg)	0.1	0.155	0.19	0.21
Quantity (PCS)/Carton	96	96	96	96
GW/Carton (Kg)	11.1	17.3	21.5	24
Carton Size (L*W*H) mm	960*210*200	1260*210*200	1560*210*200	1860*210*200

Shenzhen Onn Semi-conductor lighting Co.,Ltd

Mobile : +86-18268698736 Fax: +86-755-27871421 Web: www.onnled.net

Add: Haofeng Industrial Park NO.2 Zone, Xinhe, Bao'an District, Shenzhen, China.