



Specifications

Product Name : LED Freezer Light

Model : ONN-X3F

Date : 2016-9-7

Version : A 1

Introduction:

1. X3F have all the advantages of led fixture like Energy saving, long lifespan, CCT dimmable, which is the inevitable trend.
2. All vapor sealed, don't have to concern about the water drop or moisture formed by steam.
3. Adopt high brightness SMD2835 LED chip, it features wider angle, low thermal resistance, Color area concentrated, low brightness decay with a long life span, best choice for light fixture.
4. Ingress protection is up to IP65, safe to use.
5. Slim body, diversified installation method, easy and safe.

Application: selves, cooler display, refrigerator, walk in coolers, store counters, etc.

Standard picture/size:

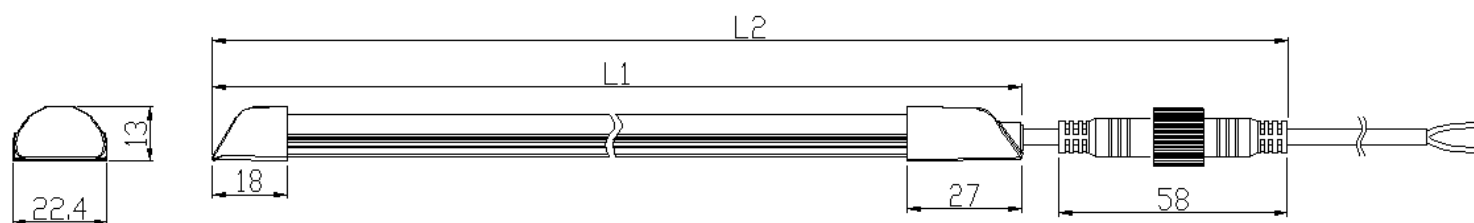
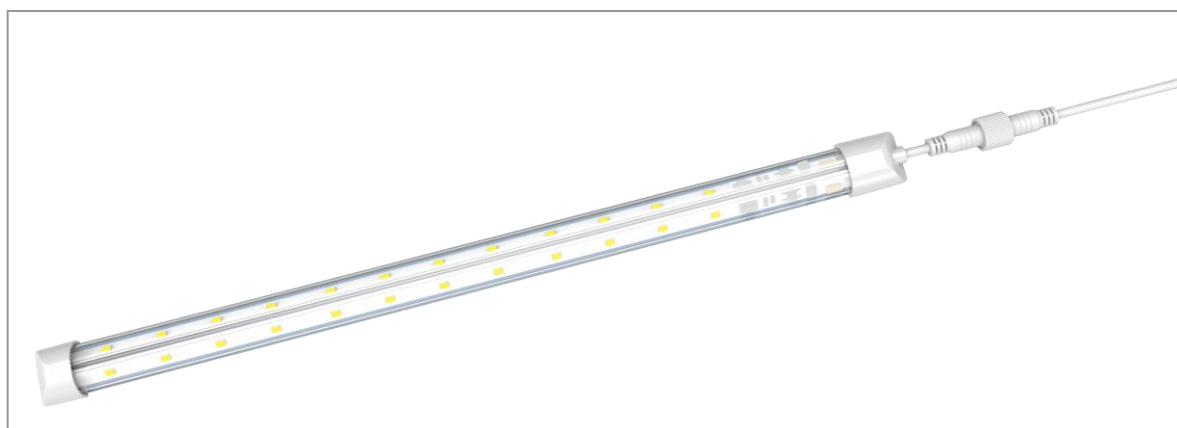

Tube length (L1)	315mm	490mm	575mm	740mm	875mm	1025mm	1175mm	1435mm
Fitting length (L2)	380mm	555mm	640mm	805mm	940mm	1090mm	1240mm	1500mm

Specification:

Model	Input voltage	Voltage range		CCT				
<input type="checkbox"/> ONN-X3F-C1	AC220V (50/60Hz)	AC200-240V (50/60Hz)		5500-6000K				
<input type="checkbox"/> ONN-X3F-C2	AC220V (50/60Hz)	AC200-240V (50/60Hz)		4000-4500K				
<input type="checkbox"/> ONN-X3F-C3	AC220V (50/60Hz)	AC200-240V (50/60Hz)		2800-3000K				
Installation	<input type="checkbox"/> Metal clip <input type="checkbox"/> Double side tape <input type="checkbox"/> By magnet							
Light direction:	<input type="checkbox"/> left 90° emitting <input type="checkbox"/> Right 90° emitting <input type="checkbox"/> central <input type="checkbox"/> double sides 180° emitting							
Length:	315	490	575	740	875	1025	1175	1435
Watt.(220V):	8W	11W	12W	16W	18W	20W	24W	30W
IP	IP65		CCT:		5500-6000K 4000-4500K 2800-3000K			
Lumens efficiency	85-95Lm/W		CRI:		>80Ra			
Driver:	Non-isolated		Power factory:		>0.9			
Surface temperature:	< 50°C		Emitting angle:		110°/ 200°			
Lifespan	50,000H							

Environment requirement:

Working temperature	-20~45°C
Storage temperature	-40~70°C
Working humidity	10~90%
Storage humidity	10~90%

Package:

Material	Carton											
Spec. (MM)	315 (s)	315 (D)	490 (s)	490 (D)	875 (s)	875 (D)	102 5(s)	1025 (D)	1175 (s)	1175(D)	1435 (s)	1435 (D)

Shenzhen Onn Semi-conductor lighting Co.,Ltd

Web: www.onnled.net

Add: F, Haofeng Industrial Park NO.2 Zone, Xinhe, Bao'an District, Shenzhen, China.

Net weight (Kg)	0.05	0.06	0.1 5	0.1 7	0.1 05	0.12 5	0.1 2	0.14	0.14	0.165	0.17 5	0.205
Total gross weight (Kg)	9	11	13. 5	15. 5	9.8 2	11.5	11. 2	13	13	15.1	16.2	18.7
Qty/Carton(PCS)	168		168		84		84			84		
EPE Foam (L*W*H)mm	200*150*15											
Carton size (L*W*H)mm	660*210*200		1260*210*200		960*210*200		1260*210*200			1560*210*200		

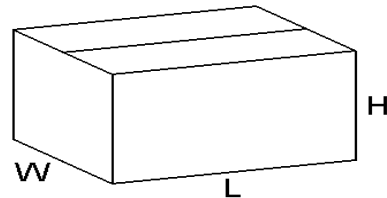
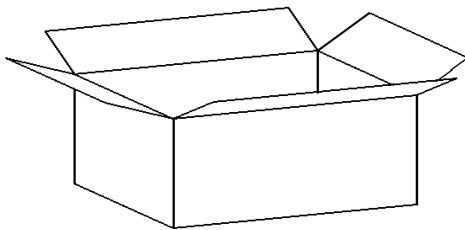

Installation:

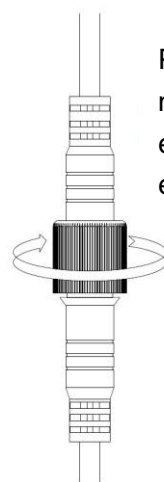

! Warning

Please tighten the nut in central for an excellent waterproof effect.

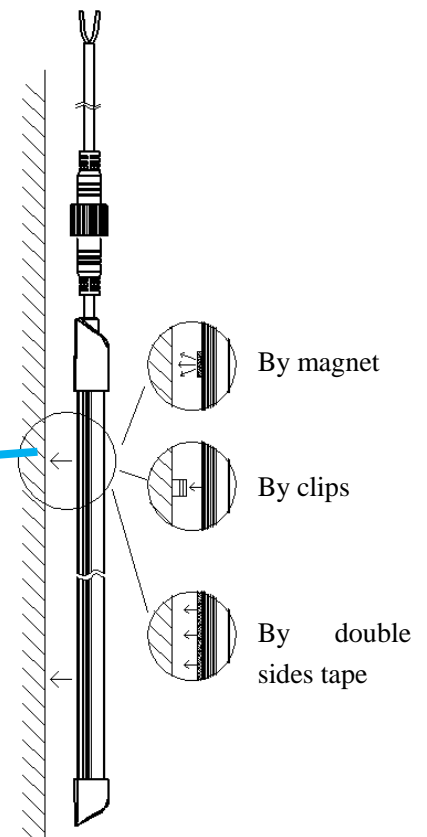

1) Three installation methods:

- By magnet: metal plate surface mounted.
- By clips: fixed the clips by screw, push the light into clip.
- By double sides tape: tear off the protector on tape, stick the light to the right location like right picture showed.

2) Plug the male and female connector in right way, then tighten the nut in central.
Mark: details check the pictures below.

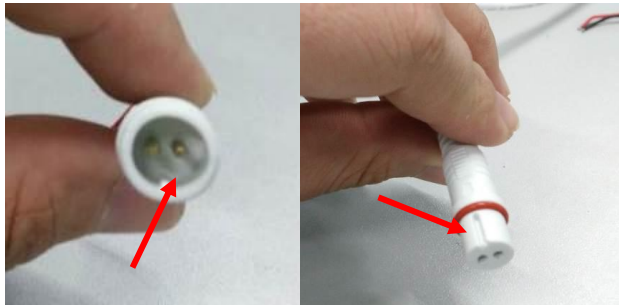

Male connector

Female connector



Repair Rule

The warranty of the products is 24 months. If broken in natural within the warranty, please bring invoice and date in the light to repair free.

The following cases are not covered by the warranty, service charges paid by:

- (1) Altered fixture dates
- (2) The broken is because of improper use by user;
- (3) The body of light and bundled products is broken or lost can't warranty;
- (4) The broken reason is not natural, such broken by wrong input voltage and set up to lead to light can't work;
- (5) Dismantle and repair have not agree with factory, repair and alter by the other repair

person not in authorized service station;

(6) The broken is caused by fires, earthquakes, floods, lightning or other natural disasters, pollution and abnormal voltage.

(7) Lights need to repair because rodents, salt spray, corrosion.

Exceed warranty period, repair will be charge fees as standard. Service charge = repair fees + material fees + freight fees.